

Animal Feed Milling

Tapered Multiple-Shaft Screw Feeders BU

11

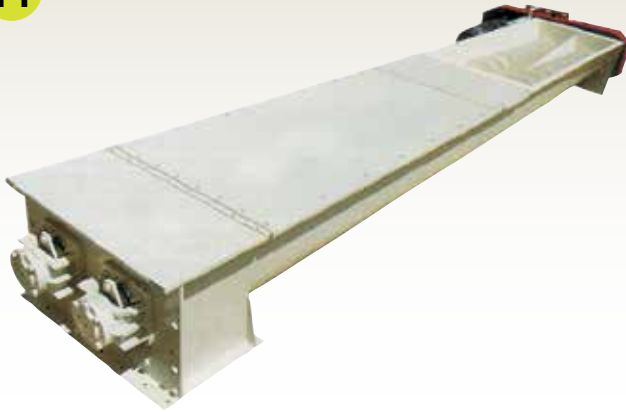

Description ▼

BU are Multiple-Shaft Screw Feeders with tapered screws and tapered trough. They come with 2, 3, 4, 5 or 6 screws in a single trough.

In the basic configuration they consist of:

- One or more direct-mounted drives each drive powering two screws;
- Gear transmission;
- Modular trough;
- Tapered screws;
- Flow intercepting diaphragm to avoid material flushing;
- No intermediate bearings;
- Splined shaft couplings;
- Flanged end bearing assemblies opposite drive end;
- Mild steel design.

Function ▼

| Feeding from silos flour, derivatives (cereals, coarse powders, fine powders, mash, bran).



Applications ▼

BU Multiple-Shaft Screw Feeders are installed beneath flour or bran silos when bin activators cannot be used. Furthermore they are used under silos for by-products. BU Feeders can be used instead of MMU-type Live Bin Bottoms. The advantage of BU over a live bin bottom is a more efficient extraction of the material as there is no jamming.

Benefits ▼

- ✓ Progressive material feeding in the open trough (inlet) section ensuring accurate material flow from the silo;
- ✓ Modular trough design enables easy access to internal components without the need of drop-bottom troughs and/or inspection hatches;
- ✓ Reduced, easy and quick maintenance;
- ✓ Minimised material residue.

Animal Feed Milling

Tapered Multiple-Shaft Screw Feeders BU



Technical Features / Performance ▼

- ▶ Wide range from Ø 150 to 500 mm;
- ▶ Feed rates up to 200 m³/h;
- ▶ Modular overall lengths in steps of 500 mm;
- ▶ Variable length open trough section depending on silo outlet dimensions;
- ▶ Fixed tapered screw and trough length;
- ▶ Accurate finishing (no steps or niches);
- ▶ Direct drive (directly connected with screw) with either direct power transmission, linear shaft coupling, offset chain transmission, or offset belt transmission;
- ▶ End bearing assemblies with long-life lubricated bearings and adjustable Teflon[®] seals;
- ▶ Wide range of accessories and options: over-flow hatches with safety grid, tubular trough inserts, trough feet, rotation detectors, flow interception diaphragms.

Overall Dimensions ▼

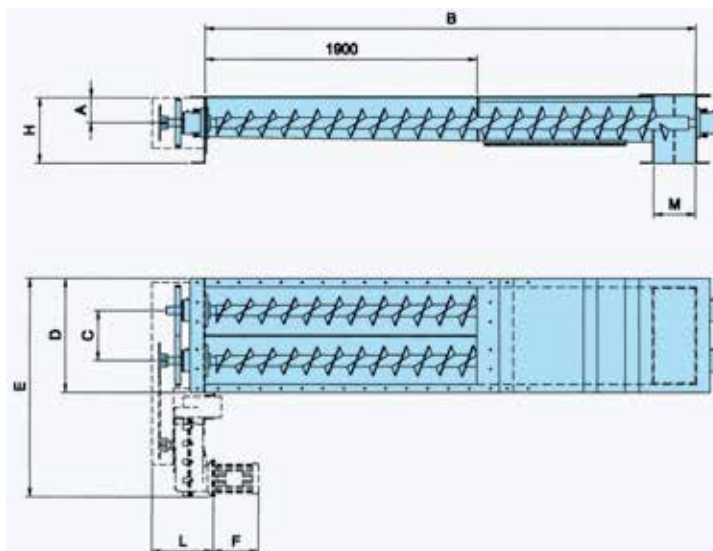

Screw Ø	Gear Reducer	A	B	C	D	E *	F *	H	L *	M	N	kg
BU 150	S 41	115	2,500	165	433	845	391	260	232	175	343	216
	S 43	115	2,500	165	433	903	510	260	232	175	343	236
BU 200	S 43	135	3,000	220	535	1,023	491	320	275	225	445	356
BU 250	S 43	160	3,000	270	635	1,128	372	375	275	275	545	416
	S 45	160	3,000	270	635	1,195	670	375	275	275	545	476
BU 300	S 45	195	3,000	315	750	1,305	662	440	283	325	640	540
	S 47	195	3,000	315	750	1,325	666	440	283	325	640	606
BU 350	S 45	235	3,000	380	865	1,425	662	510	283	375	755	760
	S 47	235	3,000	380	865	1,448	666	510	283	375	755	920
BU 400	S 47	270	3,500	425	965	1,550	685	575	317	425	850	1,077
BU 500	S 47	340	3,500	520	1,175	1,778	685	720	317	525	1,045	1,234

* Approx. dimensions

Dimensions in mm

This datasheet does not show the complete range but only the models most suitable for the application.



WAM[®]



www.wamgroup.com